



Pandolfo Alluminio

PACKAGING AND LOGISTICS
ALUMINIUM PROFILES AND COMPONENTS



PACKAGING OF PROFILES

AT PANDOLFO ALLUMINIO FACTORIES, PROFILES ARE WRAPPED AND PACKED FOR SHIPMENT BOTH AUTOMATICALLY USING MODERN ROBOTIZED SYSTEMS, AND MANUALLY, BY SPECIALLY TRAINED PERSONNEL.

COVERINGS

THE SIDES OF THE PACK ARE WRAPPED WITH POLYTHENE BEFORE SHIPMENT, TO PROTECT AGAINST RUBBING AND SCRAPING CONTACT THAT COULD OCCUR IN HANDLING.



MAIN ELEMENTS OF PACKAGING

DIMENSIONS (MM)

W WIDTH	STANDARD 570	MAXIMUM 680
H HEIGHT	STANDARD 550	MAXIMUM 550
L LENGTH	STANDARD FROM 5000 TO 8000 (UNTREATED PROFILES) STANDARD FROM 5000 TO 7200 (TREATED PROFILES)	
WEIGHT	MAXIMUM 1000 KG	

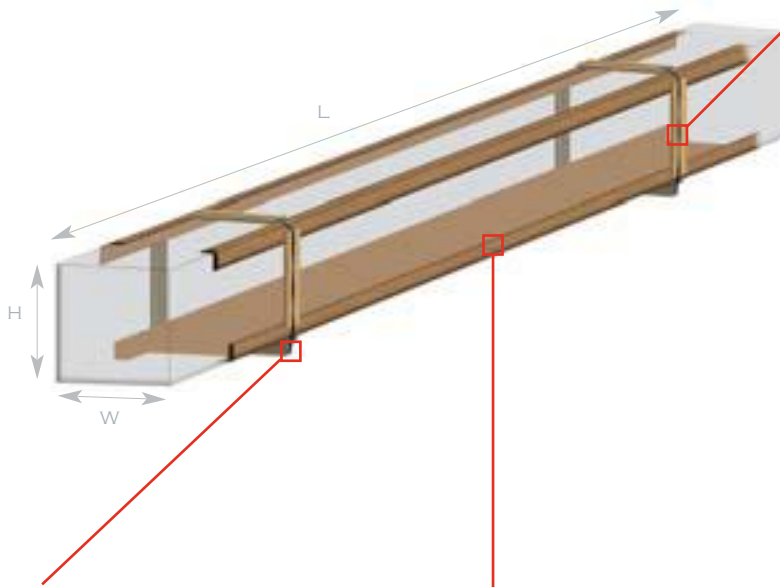

STRAPPING WITH METAL OR PLASTIC BANDS AND WOODEN BATTENS

THE ASSEMBLED PACK IS SECURED WITH TWO OR MORE STRAPPING BANDS OF METAL OR PLASTIC MATERIAL. WOODEN BATTENS ARE LOCATED BETWEEN THE STRAPS AND THE PROFILES, ON THE TOP AND BOTTOM FACES OF THE PACK. THE BATTENS FITTED TO THE SIDE FACES OF THE PACK ARE GROOVED, AND DESIGNED TO GIVE SHAPE AND PROTECTION.



BLOCKS (OPTIONAL)

DESIGNED TO ALLOW EASY INSERTION OF LIFT FORKS, THESE BLOCKS MEASURE 80X80 MM AND ARE PROVIDED ON REQUEST. DISTANCE BETWEEN CENTRES 3400 MM.



CARDBOARD ANGLES AND CARDBOARD BASE (OPTIONAL)

THE PACK CAN BE FITTED WITH BOTTOM CARDBOARD ANGLES AND A CARDBOARD BASE SHEET FOR EASE OF HANDLING WITH A FORK LIFT, AND FOR ADDED PROTECTION. THERE IS ALSO THE OPTION OF TOP CARDBOARD ANGLES AND A CARDBOARD TOP COVER SHEET.



BASE FRAME (OPTIONAL)

A BASE MADE OF WOODEN BOARDS AND BATTENS, RECOMMENDED FOR PACKS OF PROFILES HAVING LIMITED RIGIDITY. THE ADDITION OF A BASE FRAME IS AGREED SPECIFICALLY BEFOREHAND.



PROTECTION OF PROFILES

IT IS ESSENTIAL THAT PROFILES ARE PROTECTED DURING TRANSPORT AND HANDLING, IN ORDER TO PREVENT DAMAGE THAT COULD ADVERSELY AFFECT THEIR FUNCTIONAL EFFICIENCY AND APPEARANCE. THE LEVEL OF THIS PROTECTION IS LINKED TO THE FINAL APPLICATION OF THE PROFILES. THE HIGHER THE VISUAL QUALITY REQUIRED IN USE, THE GREATER THE PROTECTION NEEDED, AND CONSEQUENTLY THE HIGHER THE COSTS INVOLVED IN TERMS BOTH OF MATERIAL AND OF PREPARATION TIME. THE DESIGN OF THE BEST PACKAGING SOLUTION IS THEREFORE AN IMPORTANT FACTOR, TAKING INTO ACCOUNT THE GEOMETRY OF THE PRODUCT AND THE VISUAL, FUNCTIONAL AND ECONOMIC REQUIREMENTS SPECIFIED BY THE CUSTOMER, WHICH MUST BE AN INTEGRAL PART OF THE PROJECT FROM THE VERY EARLIEST STAGES.



PACKAGING WITH NO INTER-LAYER PROTECTION

UNTREATED PROFILES WITH NO PARTICULAR PROTECTION REQUIREMENTS.

MINIMAL PROTECTION
MODERATE COST



POLYTHENE BETWEEN LAYERS

UNTREATED OR TREATED PROFILES REQUIRING PARTIAL PROTECTION.

MEDIUM PROTECTION
MEDIUM COST



POLYTHENE BETWEEN BUNDLES

PROFILES REQUIRING HIGH LEVELS OF PROTECTION (E.G. "DECORATIVE" CLASS)*.

GOOD PROTECTION
MEDIUM COST



BUNDLE SPIRAL-WRAPPED IN POLYTHENE OR PAPER

UNTREATED OR TREATED PROFILES REQUIRING HIGH LEVELS OF PROTECTION. THIS KIND OF PACKAGING FACILITATES OPERATIONS THAT MAY BE CARRIED OUT ON THE ENTIRE BUNDLE, AND ENSURES CONTINUED PROTECTION EVEN OF PARTLY OPENED PACKS.

OPTIMUM PROTECTION
APPRECIABLE COST

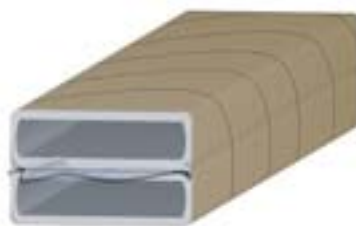

BUNDLES SPIRAL-WRAPPED IN POLYTHENE OR PAPER WITH POLYTHENE INTERLAYER

UNTREATED OR TREATED PROFILES REQUIRING PARTICULARLY HIGH LEVELS OF PROTECTION. THIS KIND OF PACKAGING FACILITATES OPERATIONS THAT MAY BE CARRIED OUT ON THE ENTIRE BUNDLE, AND ENSURES CONTINUED PROTECTION EVEN OF PARTLY OPENED PACKS.

MAXIMUM PROTECTION
HIGH COST



STRIPS BETWEEN LAYERS

IN THE CASE OF CERTAIN PROFILE GEOMETRIES, THE STABILITY OF THE PACK CAN BE INCREASED BY LOCATING CARDBOARD STRIPS OR WOODEN LATHS BETWEEN THE LAYERS.

GOOD PROTECTION
MEDIUM COST

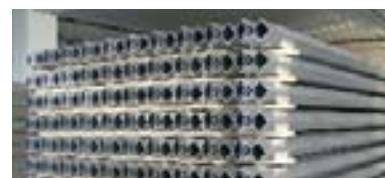

(*) CLASSIFICATION AS IN EN12373-1

TYPICAL PACKAGING SOLUTIONS

ILLUSTRATED BELOW, BY WAY OF EXAMPLE, ARE CERTAIN OF THE PACK CONFIGURATIONS MOST COMMONLY USED FOR PROFILES SEVERAL METRES IN LENGTH. OTHER CONFIGURATIONS ARE POSSIBLE, UTILIZING DIFFERENT COMBINATIONS OF THE VARIOUS PACKAGING ELEMENTS.



34_11

IMBALLO
SPIRAL WRAPPED CREPE
PAPER
CARDBOARD STRIPS
BETWEEN LAYERS

PACK
TWO STRAPS
TOP AND BOTTOM
BATTENS



42_11

PACKAGING
POLYTHENE BETWEEN
BUNDLES

PACK
TWO STRAPS
TOP AND BOTTOM BATTENS

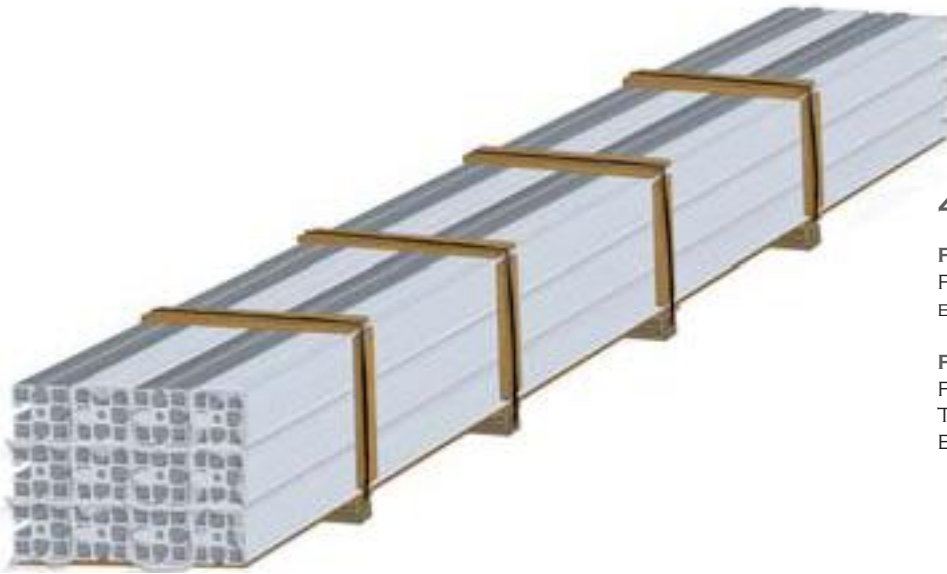

43_62

PACKAGING
POLYTHENE BETWEEN
BUNDLES

PACK
FOUR STRAPS
TOP AND SIDE BATTENS
BLOCKS



42_43

PACKAGING
SPIRAL WRAPPED
POLYTHENE
CARDBOARD STRIPS
BETWEEN LAYERS

PACK
FOUR STRAPS
TOP AND SIDE BATTENS
BOTTOM ANGLES
BLOCKS

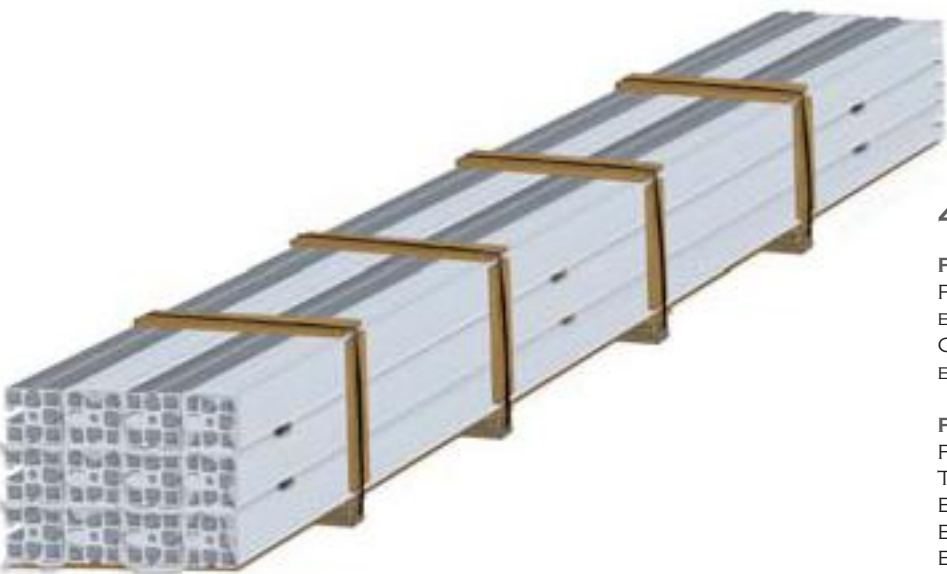

43_68

PACKAGING
POLYTHENE BETWEEN
BUNDLES
CARDBOARD STRIPS
BETWEEN LAYERS

PACK
FOUR STRAPS
TOP AND SIDE BATTENS
BLOCKS
BASE FRAME
BLOCKS

SPECIAL PACKAGING

PANDOLFO ALLUMINIO CAN ALSO CATER FOR SPECIFIC PACKAGING NEEDS, PREPARING AND PROVIDING CUSTOMIZED SOLUTIONS BY PRIOR AGREEMENT WITH THE CUSTOMER.

PACKAGING FOR PROCESSED COMPONENTS

THE NATURE OF PACKAGING FOR PROCESSED ITEMS IS PARTICULARLY DEPENDENT ON SIZE AND TYPE. THIS BEING THE CASE, PACKAGING CONSTITUTES AN INTEGRAL PART OF THE DESIGN PROCEDURE AND MUST BE EVALUATED FOR EACH SINGLE ITEM.

SURFACES EXPOSED TO VIEW CAN BE SEPARATED FROM ONE ANOTHER WHEN NECESSARY TO ENSURE THAT SURFACES ARE PROTECTED; THIS IS DONE NORMALLY BY INTERPOSING CARDBOARD STRIPS, OR SHEETS OF NYLON OR TISSUE PAPER. ILLUSTRATED BELOW ARE A NUMBER OF TYPICAL PACKAGING SOLUTIONS FOR PROCESSED COMPONENTS, AS USED AT PANDOLFO ALLUMINIO PRODUCTION SITES.

PALLETS

COMPONENTS ARE ARRANGED ON PALLETS AND WRAPPED IN POLYTHENE SHEETING. ANGLES ARE FITTED TO THE OUTER CORNER EDGES, AND THE ENTIRE PACK IS MADE SECURE WITH TWO OR MORE STRAPS. IF REQUESTED, AND DEPENDING ON THE TYPE OF PRODUCT, PACKS CAN ALSO BE MADE STACKABLE.



BOXES ON PALLETS

COMPONENTS ARE ARRANGED WITH SUITABLE PROTECTIVE PACKAGING IN CARDBOARD BOXES, WHICH ARE THEN POSITIONED ON THE PALLET AND OVERWRAPPED IN POLYTHENE. THE PACK IS COMPLETED WITH ANGLES AND STRAPS. THIS TYPE OF PACKAGING IS SUITABLE FOR SMALL SIZE COMPONENTS.



CRATES

IF REQUESTED, WHERE MATERIAL IS TO BE TRANSPORTED LONG DISTANCES AND COMPONENTS ARE PARTICULARLY DELICATE AND VULNERABLE, CUSTOMIZED CRATES CAN BE DESIGNED AND ASSEMBLED.



SPECIAL PACKAGING

PANDOLFO ALLUMINIO CAN ALSO CATER FOR SPECIFIC PACKAGING NEEDS, PREPARING AND PROVIDING CUSTOMIZED SOLUTIONS BY PRIOR AGREEMENT WITH THE CUSTOMER, OR ALTERNATIVELY, USING THE CUSTOMER'S OWN PACKAGING. FOR FURTHER INFORMATION OR CLARIFICATION, CONTACT OUR SALES OFFICE.



PACK IDENTIFICATION AND TRACEABILITY

LABELLING IS FUNDAMENTALLY IMPORTANT IN PROVIDING CORRECT INFORMATION ON GOODS FOR SHIPMENT. EVERY PACK OR PALLET DESPATCHED BY PANDOLFO ALLUMINIO IS MARKED WITH A LABEL SHOWING AN INDIVIDUAL IDENTIFICATION NUMBER, AND ALL ITEMS OF INFORMATION REQUIRED BY COMPANY PROCEDURE. THE LABEL SHOWS ESSENTIAL SHIPMENT DETAILS: RECIPIENT AND ADDRESS / WEIGHT / NUMBER OF PIECES, ETC. OTHER INFORMATION THAT CAN BE ADDED, IF REQUESTED, INCLUDES THE PART NUMBER AND ORDER NUMBER ATTRIBUTED BY THE CUSTOMER, IN ORDER TO FACILITATE SWIFT AND RELIABLE IDENTIFICATION OF THE MATERIAL.

STANDARD DELIVERY TIMES

THE FOLLOWING TABLE INDICATES OUR STANDARD DELIVERY TIMES. THE INFORMATION IS INDICATIVE, AND REFLECTS A SITUATION IN WHICH THE FACTORY IS OPERATING ON A NORMAL WORKLOAD. THE WEEK IS A WORKING WEEK, NOT A CALENDAR WEEK.

PROFILES IN STRAIGHT LENGTHS			PROCESSED COMPONENTS
STOCK PROFILES	ASEXTRUDED	3-4 WEEKS	DELIVERY TIMES DEPEND ON THE TYPE AND COMPLEXITY OF THE PROCESSING; ACCORDINGLY, THE NUMBER OF WEEKS WILL BE CALCULATED AT THE DESIGN AND/OR SCHEDULING STAGE FOR THE ARTICLE IN QUESTION.
	ASEXTRUDED, ALLOY TO EN AW 6005/6082 WITH SURFACE TREATMENT	5 WEEKS	
		+ 1-2 WEEKS	
NEW PROFILES (SAMPLE PRODUCTION)	ASEXTRUDED WITH SURFACE TREATMENT	6-7 WEEKS	
		+ 2-3 WEEKS	

SHIPPING AND TRANSPORT

EMPLOYING THE SERVICES PROVIDED BY A DEPENDABLE NETWORK OF CARRIERS, WHOSE EFFICIENCY AND CARE ARE MONITORED ON A PERMANENT BASIS, PRODUCTS ARE TRANSPORTED SWIFTLY AND SAFELY TO THE PREMISES OF THE CUSTOMER. CUSTOMERS ARE KEPT PROMPTLY AND REGULARLY INFORMED AS REGARDS THE STATUS AND LOCATION OF GOODS IN TRANSIT, SO AS TO ENABLE EFFICIENT AND TIMELY MANAGEMENT OF THE MATERIAL.

SHIPPING DOCUMENTS

CONSIGNMENT NOTE

AS REQUIRED BY COMPANY PROCEDURES AND CURRENT REGULATIONS, NOTABLY THE CMR (CONVENTION ON INTERNATIONAL CARRIAGE OF GOODS BY ROAD), ALL MATERIAL DESPATCHED BY PANDOLFO ALLUMINIO IS ACCOMPANIED BY A CONSIGNMENT NOTE SHOWING DETAILS OF THE MATERIAL BEING SHIPPED. THE DOCUMENT IS COMPILED AND SIGNED BOTH BY PANDOLFO ALLUMINIO AND BY THE APPOINTED CARRIER. GOODS IN TRANSIT ARE INSURED AGAINST TRANSPORT-RELATED DAMAGE AND THEFT.

SHIPPING NOTIFICATION

PANDOLFO ALLUMINIO NOTIFIES THE CUSTOMER THAT THE SHIPMENT HAS BEEN DESPATCHED, BY FAX OR E-MAIL, SO AS TO FACILITATE PREPARATIONS FOR TAKING RECEIPT OF THE MATERIAL AT THE DESTINATION ADDRESS.

QUALITY DOCUMENTS

WHERE AGREED WITH THE CUSTOMER AND/OR DICTATED BY THE NATURE OF THE MATERIAL SUPPLIED, PANDOLFO ALLUMINIO WILL PREPARE THE APPROPRIATE CERTIFICATES, TYPE 2.1 OR TYPE 3.1, IN CONFORMITY WITH EN 12204 STANDARD, WHICH ARE FAXED OR E-MAILED TO THE CUSTOMER AT THE TIME OF DESPATCHING THE MATERIAL.

STANDARD TRANSPORT TIMES

THE MAP SHOWS MAXIMUM DELIVERY TIMES (INDICATIVE) THAT CAN BE EXPECTED FOLLOWING DEPARTURE OF A SHIPMENT FROM THE PREMISES OF PANDOLFO ALLUMINIO. THE DETAILS SHOWN REFER TO DELIVERY TIMES FOR A FULLY LADEN GOODS VEHICLE.

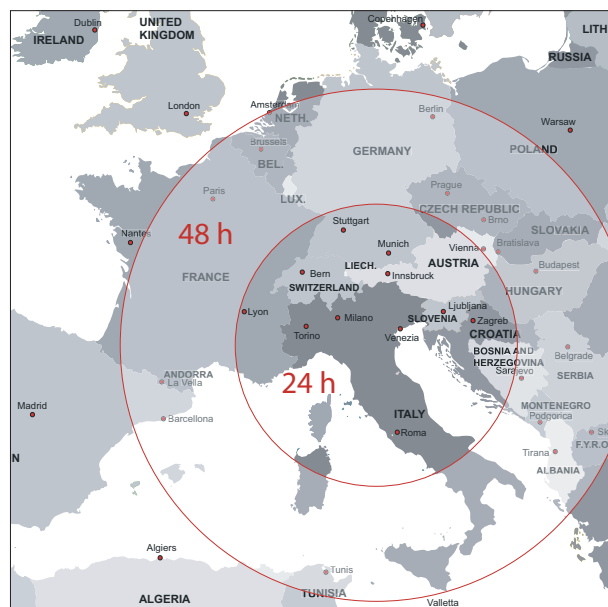



Pandolfo Alluminio

VIA DELLA PROVVIDENZA, 143
35030 SARMEOLA (PD) - ITALY
TEL. +39 049 822 6 000
FAX +39 049 822 6 050
WWW.PANDOLFOALLUMINIO.COM
INFO@PANDOLFOALLUMINIO.COM

ITALY - SLOVENIA

SALES OFFICE - ITALY
TEL. +39 049 822 6 087
FAX +39 049 632 956
SALES@PANDOLFOALLUMINIO.COM

ALL EUROPEAN AND EXTRA-EUROPEAN CUSTOMERS

SALES OFFICE - EXPORT
TEL. +39 049 822 6 000
FAX +39 049 897 7 208
EXPORT@PANDOLFOALLUMINIO.COM